

Ecosystèmes d'enseignement extérieurs

Concours d'idées
étudiants et jeunes diplômés

Outdoor learning ecosystems

Student and young graduate's
competition

Date limite d'inscription : le 15 novembre 2021

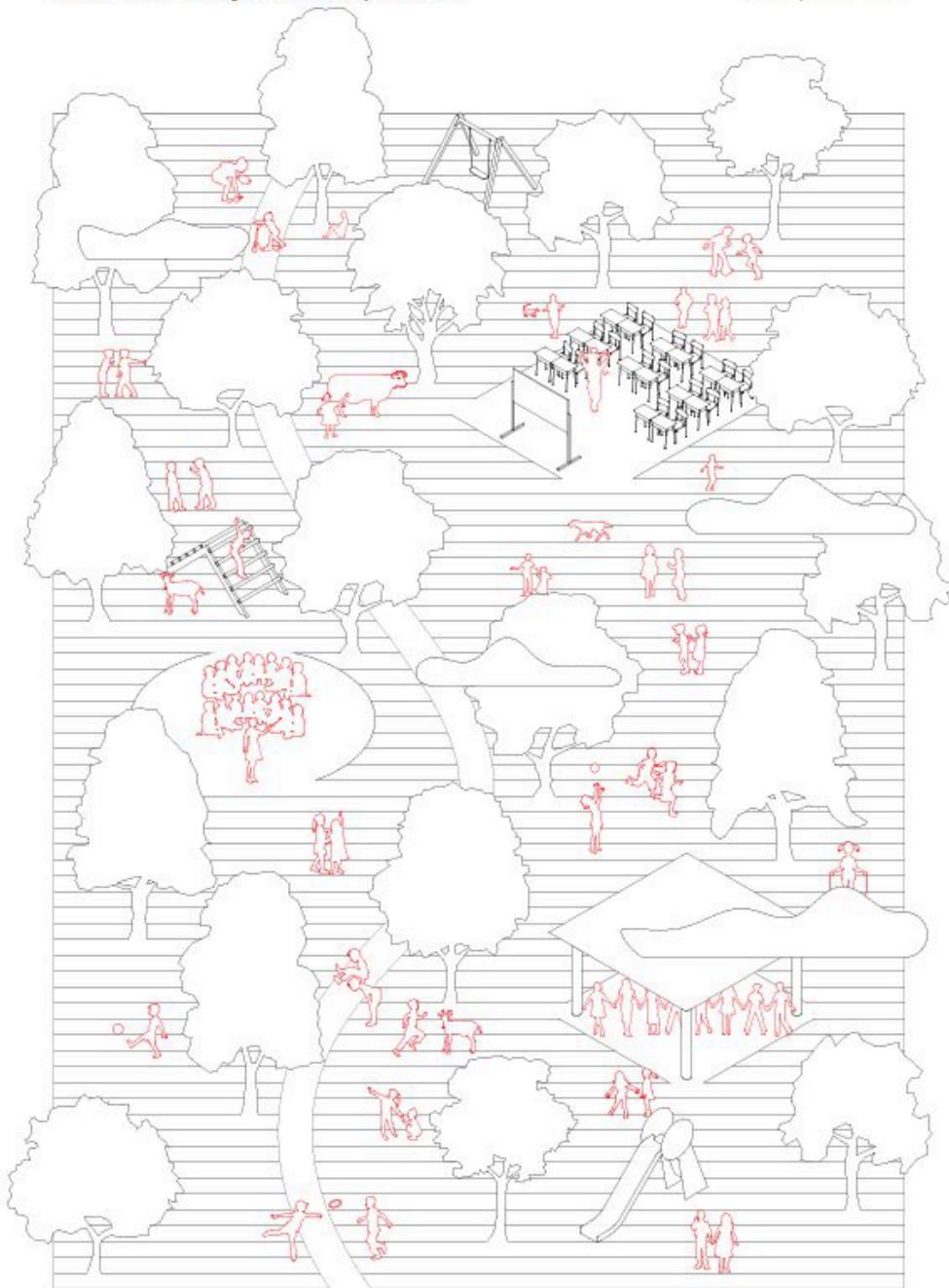

Repense les lieux d'enseignement !

Renseignements et inscriptions :
<http://www.nancy.archi.fr/fr/resilience-grand-est.html>

Contact: concours.resilience@nancy.archi.fr

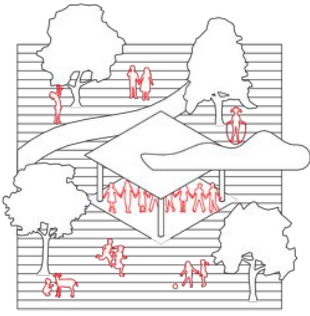

Outdoor learning ecosystems

Competition rules

Competition for ideas carried out in the framework of the research “Schools in the time of Covid-19” (LHAC, ENSA-Nancy, LIEC, UL & SnT, UniLu) Research programme “Resilience”, funded by the Grand-Est Region & ANR.

Context & purpose

This ideas competition is part of the research project “School architecture at the time of the Covid-19”, carried out by a multidisciplinary team of researchers from the LHAC (Ecole Nationale Supérieure d’Architecture de Nancy) and co-financed by the Région Grand-Est and the ANR (Agence Nationale de la Recherche) as part of the call for projects “Resilience”, launched in May 2020. This research aims on the one hand to question the spatial, pedagogical and psychosocial impacts of the Covid-19 epidemic in schools in the Grand-East Region and Luxembourg, and on the other hand the possibility of rethinking school spaces on the basis conclusions, so that they can best respond to a post-Covid issues (health, but also climate and environmental, educational and social).

Problems and issues

The objective of the competition will be to propose a project for a place(s) that allows for a reappropriation of the outdoor spaces of a high-school, which are often made up of few vegetated surfaces, and whose facilities limit the uses.

Beyond to be able to respond to the health issue of air renewal, teaching outside is the approach proposed here to rethink jointly :

- educational issues (How to teach outdoors? How can the elements of biodiversity be thought as actual teaching supports? How can this development contribute to rethinking educational forms that are beneficial to a diversity of audiences?)
- environmental issues (how can this installation contribute to the ecosystemic balance of the site? How can it support education-related uses in a climate context that is undergoing profound change?)

Requirements for the answers

The objective of this competition is thus to imagine an outdoor teaching unit that responds to the above-mentioned challenges, through a structure or

development or design for a class of up to 40 students, and remain in place in all seasons. Interventions in the ground should be minimal, to ensure both ease of installation and ease of installation and adaptability of the project.

Two examples of colleges in the Grand-East region will be used to support the reflection. The proposed projects should be adaptable to at least these two situations. But a reflection will also have to be undertaken to consider the adaptability of the project to other existing high schools (still in the Grand-East Region). All the graphic documents produced for the report may relate to only one of the situations, but at least one graphic document must show the adaptability of the project to the second high school situation.

A series of graphic documents presenting these high schools will be provided to the participants (see below).

Participation & registration

The competition is open to students of the Nancy and Strasbourg National Schools of architecture of Nancy and Strasbourg, as well as students of the INSA-Strasbourg and the master architecture of the University of Luxembourg. It is also open to young graduates of these schools, i.e. those who obtained their master's degree less than three years ago (i.e. after September 2018). It is possible to participate alone, or in a team of 2 or 3 people. Teams must be composed of at least one student in architecture or a young architect, and possibly one or two other students or young graduates (in the field of architecture or in the fields of humanities and social sciences, including education sciences, or natural sciences, including biology). A copy of the student card or diploma will be required as proof of at the time of registration.

NB: Although it is not mandatory, the multidisciplinary nature of the teams will be appreciated during the evaluation of the projects.

How to register

Registration is open from 18 October to 15 November 2021 at midnight. The registration form (see below) should be returned in pdf format by email (concours.resilience@nancy.archi.fr).

Once this form has been received, the elements specified below will be made available to the participants.

Elements available to participants

The two college situations are each presented by the following

following documents:

- two situation plans on a scale of 1:5000°
- a 1/1000° ground plan
- an axonometry of the distribution of functions
- a serie of photos

NB: The documents will be sent once the registration form has been duly completed and returned. The participants will have to commit themselves not to not to distribute or use the documents sent outside the framework of this competition.

A layout template will also be sent (Indesign and Jpeg files) : the rendering plates must imperatively use this template (for the exhibition that will follow the competition).

Expected results

The submission will consist of one to four A1 plates, which must respect the template sent at the time of registration: these plates must be sent by e-mail before 6 January 2022 (see terms and conditions of submission). The choice of the graphic pieces is left to the appreciation of the participants. However, they must include a title and even a legend. The plates may also include text. This text (as well as all the written elements of the plates), may be indicated in in French and/or English.

NB: all plates must contain the name of each team member.

How to submit

The A1 sheets must be sent by e-mail to the following address concours.resilience@nancy.archi.fr in pdf format no later than midnight on 6 January 2022 at midnight.

These plates will be printed by ENSA-Nancy for the jury which will be held which will take place on 11 January 2022.

Please note: the plates must include the name of each team member. Furthermore, the organisers cannot be held responsible for any technical problems for any technical problems related to the reception of the documents.

Contest Jury

The jury will be chaired by Matali Crasset, designer and author of numerous objects, furniture, scenography and interior design in France and abroad. The members of the jury will be:

- Gauthier Bolle, architect DPLG, Doctor of History of Art and architecture, lecturer in history and architectural culture at ENSA-Strasbourg, researcher at ARCHE (University of Strasbourg);
- Virginie Derveaux, architect DPLG, teacher at ENSA-Nancy, associate researcher at the LHAC;
- Sylvie Dousset, Professor of soil sciences at University of Lorraine, researcher at the LIEC;
- Charles Max, Professor of Education Sciences, University of Luxembourg, researcher at SnT Luxembourg, researcher at SnT ;
- Maurice Mazalto, expert and consultant in school architecture for local authorities;
- Benoît Sindt, architect DPLG, teacher at ENSA-Nancy.

Evaluation criteria

The proposed projects will be evaluated by the jury on 11 January 2022, in particular on the basis of the following criteria

- the architectural qualities of the project ;
- response to the constraints of the project (adaptability, number of pupils, etc.) ;
- consideration of the constructional dimension ;
- response to health, environmental and climatic issues, educational and social issues;
- positioning defended in the project and innovation.

Winning projects and prizes

The first three projects will receive a prize: 1st prize, 1500 euros, 2nd prize, 1000 euros, and 3rd prize, 500 euros.

The materials for the production of the models of the first 5 selected projects will be supported : the winners will be able to realize the models at ENSA-Nancy model workshop. These models, as well as the competition drawings, will be presented in an exhibition, which is currently being planned. In addition to these awards, the jury reserves the right to award some special mentions.

Provisional schedule

18 October 2021: launch of the competition

15 November 2021 at midnight: deadline for registration

6 January 2022 at midnight: submission of proposals by e-mail

11 January 2022: jury and prize-giving at ENSA-Nancy

Please note: the organisers reserve the right to modify this schedule. The participants will be informed in this case.

Use of entries

By entering the competition, participants authorize the use of all their entries produced, for the purposes of information, publication and exhibition of the projects (without time limit). A right of reproduction, but not of intellectual property, is thus transferred to the competition organisers.

All documents will be used to promote the competition and the "Resilience" research.

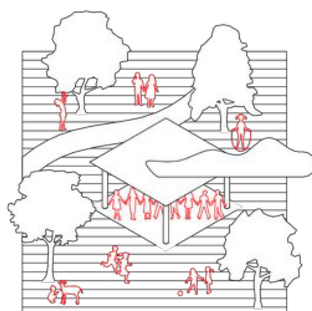

Outdoor learning ecosystems

Competition for ideas

Registration form

(1 form per team, the team can be composed of one to three participants)

Participant 1 (representative)

NAME : _____

First name: _____

Status: (please make sure to tick all the necessary boxes, and to send proof of your status, student card or copy of diploma)

- ▶ student [] ▷ ENSA-Nancy [] of ENSA-Strasbourg []
 INSA-Strasbourg [] University of Luxembourg []
 ▷ master 1 [] master 2 []
- ▶ graduate [] ▷ in 2018 [] in 2019 [] in 2020 [] in 2021 []
 ▷ ENSA-Nancy [] of ENSA-Strasbourg []
 INSA-Strasbourg [] University of Luxembourg []

Postal adress : _____

E-mail address : _____

Telephone number : _____

Participant 2

NAME : _____

First name: _____

Status: (please make sure to tick all the necessary boxes, and to send proof of your status, student card or copy of diploma)

▶ student [] ▷ in architecture [] other discipline []

if other discipline, specify : _____

school or university : _____

if architecture ▷ ENSA-Nancy [] of ENSA-Strasbourg []
 INSA-Strasbourg [] University of Luxembourg []
 ▷ master 1 [] master 2 []

▶ graduate [] ▷ in architecture [] other discipline []

if other discipline, specify : _____

school or university : _____

if architecture ▷ in 2018 [] in 2019 [] in 2020 [] in 2021 []

 ▷ ENSA-Nancy [] of ENSA-Strasbourg []
 INSA-Strasbourg [] University of Luxembourg []

Postal adress :

E-mail address :

Telephone number : _____

Participant 3

NAME : _____

First name: _____

Status: (please make sure to tick all the necessary boxes, and to send proof of your status, student card or copy of diploma)

▶ student [] ▷ in architecture [] other discipline []

if other discipline, specify : _____

school or university : _____

if architecture ▷ ENSA-Nancy [] of ENSA-Strasbourg []
 INSA-Strasbourg [] University of Luxembourg []
 ▷ master 1 [] master 2 []

▶ graduate [] ▷ in architecture [] other discipline []

if other discipline, specify : _____

school or university : _____

if architecture ▷ in 2018 [] in 2019 [] in 2020 [] in 2021 []

▷ ENSA-Nancy [] of ENSA-Strasbourg []

INSA-Strasbourg [] University of Luxembourg []

Postal adress :

E-mail address :

Telephone number : _____